

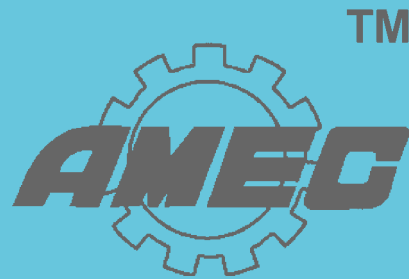

SHAFT COLLARS

(In Stock)



COLLARS

Setscrew collars K.1
Clamping collars K.2



SETSCREW COLLARS

Steel And Stainless Steel

Series-SC/SSC



STEEL BORE SIZES FROM 1/8" TO 3"

STAINLESS STEEL BORE SIZES FROM 1/8" TO 2"

ALL COLLARS COMPLETE WITH STANDARD HOLLOW POINT SETSCREWS.

ALL DIMENSIONS IN INCHES

Bore	Carbon steel zinc finish					Stainless Steel Catalog Number	UNIT PRICE
	Outside Dia.	Width	UNIT PRICE	Catalog Number	App.Wt (Lbs.)		
1/8	.36	.25	0.45	SC12	0.008	SSC12	2.00
3/16	.42	.25	0.48	SC18	0.008	SSC18	2.10
1/4	.48	5/16	0.48	SC25	0.012	SSC25	2.20
5/16	.61	5/16	0.50	SC31	0.020	SSC31	2.58
3/8	.73	3/8	0.50	SC37	0.032	SSC37	3.55
7/16	7/8	7/16	0.60	SC43	0.052	-	
1/2			0.63	SC50	0.068	SSC50	4.10
9/16	.98	.44	0.75	SC56	0.064	-	
5/8	1.11	.50	0.75	SC62	0.092.	SSC62	4.50
11/16	1.23	.56	0.81	SC68	0.128	-	
3/4		.56	0.95	SC75	0.120	SSC75	4.80
13/16	1-1/4	9/16	0.95	SC81	0.124	-	
7/8	1.48	.56	0.95	SC87	0.176	SSC87	6.50
15/16		.56	1.06	SC93	0.160	-	
1	1.50	.62	1.35	SC100	0.220	SSC100	8.13
1-1/16		.62	1.40	SC106	0.256	-	
1-1/8	1.73	.62	1.63	SC112	0.236	SSC112	8.85
1-3/16		.69	1.83	SC118	0.380	-	
1-1/4	1.98	.69	2.01	SC125	0.352	SSC125	8.85
1-5/16		11/16	2.43	SC131	0.404	-	
1-3/8	2-1/8	3/4	2.43	SC137	0.412	-	
1-7/16		.75	2.50	SC143	0.476	-	
1-1/2	2.23		2.50	SC150	0.448	SSC150	
1-9/16			3.00	SC156	0.660	-	
1-5/8	2-1/2	13/16	3.13	SC162	0.620	-	
1-11/16			3.63	SC168	0.590	-	
1-3/4	2.72		4.69	SC175	0.710	SSC175	11.50
1-13/16	2-3/4	.88	4.69	SC181	0.730	-	
1-7/8	2-3/4		4.69	SC187	0.750	-	
1-15/16		.88	4.75	SC193	0.980	-	
2	2.98		5.55	SC200	0.930	SSC200	21.00
2-1/8				SC212	0.513	-	
2-3/16				SC218	0.725	-	
2-1/4				SC225	0.675	-	
2-5/16	3-1/4	15/16		SC231	1.040	-	
2-3/8				SC237	0.980	-	
2-7/16				SC243	1.340	-	
2-1/2	3-1/2	1		SC250	1.260	-	
2-9/16	3-3/4	1		SC256	1.580	-	
2-11/16		1-1/8		SC268	2.180	-	
2-3/4	4			SC275	2.080	-	
2-15/16		1-1/8		SC293	2.020	-	
3					2.320	-	

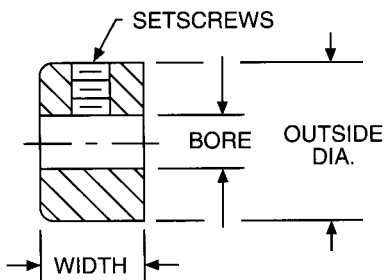

STANDARD TOLERANCES

DIMENSION		TOLERANCE
BORE	1/8-1	+ .001 + .003
	1-1/16-3	+ .001 + .004



CLAMPING COLLARS

2-Piece Type

Series-2SC/2SSC

Steel And Stainless Steel

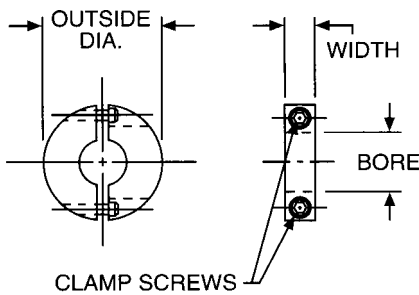

STANDARD TOLERANCES

DIMENSION		TOLERANCE
BORE	All	+0.003 -0.000

MATERIAL

Steel—Low Carbon, Black Oxide Finish
 Stainless—Type 303 Austenitic

LOAD DATA

Capacity is based on a standard steel, one-piece collar mounted with recommended screw torque on a lightly oiled shaft. Capacity is load to move collar .010". Data shown is for guidance only. In applications involving control of axial loads, capacity should be determined experimentally on actual parts involved.

Bore	Axial Load Capacity (Lbs.)	Screw Size	Recommended Screw Torque (Lb. Ins.)	
			Steel	Stainless Steel
1/8-5/16	400	4-40	20	16
3/8-7/16	600	6-32	30	24
1/2-9/16	1400	8-32	55	35
5/8-11/16	1800	10-32	90	72
3/4-1-9/16	4000	1/4-28	220	170
1-5/8-2-3/8	6500	5/16-24	435	340
2-7/16-3	8500	3/8-24	710	550

BORE SIZES FROM 1/8 " TO 3 "

ALL DIMENSIONS IN INCHES

ORDER BY CATALOG NUMBER OR ITEM CODE

Bore	Outside Dia.	Width	Clamp Screws	Steel		Stainless Steel
				Catalog Number	App. Wt (Lbs.)	Catalog Number
1/8	13/16	1/4	4-40	2SC12	0.008	-
3/16				2SC18	0.008	-
1/4				2SC25	0.012	2SSC25
5/16				2SC31	0.020	2SSC31
3/8	1-1/16	5/16	6-32	2SC37	0.032	2SSC37
7/16				2SC43	0.052	2SSC43
1/2	1-1/4	3/8	8-32	2SC50	0.068	2SSC50
9/16				2SC56	0.064	2SSC56
5/8	1-1/2	13/32	10-32	2SC62	0.064	2SSC62
11/16				2SC68	0.128	2SSC68
3/4	1-3/4	1/2	1/4-28	2SC75	0.128	2SSC75
13/16				2SC81	0.128	-
7/8	1-7/8	5/8	5/16-24	2SC87	0.176	2SSC87
15/16				2SC93	0.160	-
1	2	3/4	3/8-24	2SC100	0.220	2SSC100
1-1/16				2SC106	0.256	2SSC106
1-1/8	2-1/8	1	1/2-20	2SC112	0.236	2SSC112
1-3/16				2SC118	0.38	-
1-1/4	2-1/4	1-1/8	1/2-20	2SC125	0.352	2SSC125
1-5/16				2SC131	0.404	2SSC131
1-3/8	2-3/8	1-1/4	1/2-20	2SC137	0.412	-
1-7/16				2SC143	0.476	2SSC143
1-1/2	2-1/2	1-1/2	1/2-20	2SC150	0.448	2SSC150
1-9/16				2SC156	0.660	-
1-5/8	3	1-3/4	5/8	2SC162	0.62	-
1-11/16				2SC168	0.62	-
1-3/4	3-1/4	1-5/8	5/8	2SC175	0.71	-
1-7/8				2SC187	0.73	2SSC187
1-15/16	2	2	5/16-24	2SC193	0.75	2SSC193
2				2SC200	0.93	2SSC200
2-1/8	3-1/2	2	3/4	2SC212	0.93	-
2-3/16				2SC218	0.93	-
2-1/4				2SC225	1.04	-
2-3/8				2SC237	1.04	-
2-7/16	4	2-1/2	3/4	2SC243	1.04	-
2-1/2				2SC250	1.58	-
2-5/8	4-1/4	2-3/4	3/8-24	2SC262	1.70	-
2-11/16				2SC268	1.85	-
2-3/4	4-1/2	3	3/8-24	2SC275	2.02	-
2-7/8				2SC287	2.32	-
2-15/16	3	3	3/8-24	2SC293	2.24	-
3				2SC300	2.16	-

CALL FOR PRICE